



# AA-65

## Twin City Crossarm & Wall Bracket

### Project Information

Name Location: \_\_\_\_\_ / \_\_\_\_\_  
 Type / Quantity: \_\_\_\_\_ / \_\_\_\_\_  
 Sold to: \_\_\_\_\_  
 PO#: \_\_\_\_\_

### Approvals

#### Crossarm Details

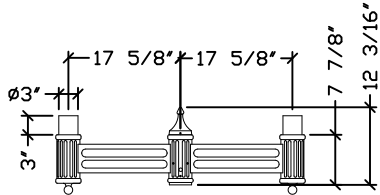

Post Top Mounting

#### Wall Bracket Details

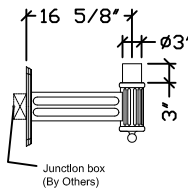

Junction box (By Others)

### Specifications

#### Construction:

All cast aluminum parts shall be low copper alloy A356. All extruded aluminum parts shall be alloy 6061-T6, 6063-T5 or equal.

#### Crossarm Installation:

The crossarm is designed to slip over a 4" H x 3" O.D. tenon and is secured with six stainless steel set-screws and one through bolt. The mounting adaptor shall be designed for 1.5G vibration conditions, when used with a Beacon Products luminaire.

#### Wall Bracket Installation:

The wall bracket is anchored to the wall by four mounting bolts, which are not provided by Beacon as their size (maximum diameter of 3/8") and depth will vary according to the type of wall. The maximum projection of the mounting bolts is 1.5". The junction box is not supplied by Beacon, however the bracket was designed to conceal a fully recessed rectangular single-gang junction box.

#### EPA (Effective Projected Area):

EPA is defined as (Surface Area x Drag Coefficient). Allowable Pole, Luminaire Arm, Luminaire and Accessory EPAs are derived from the most current published AASHTO standard (American Association of State Highway and Transportation Officials), currently AASHTO 2001. Customer assumes all responsibility for selecting the appropriate pole for installation. Luminaire Arm, Luminaire and Accessory EPA must be equal to or less than allowable EPA of pole. Consult a professional engineer for compliance with local codes and standards.

#### Fasteners:

All fasteners (where provided) shall be stainless steel. When tamper resistant fasteners are required, spanner HD (snake eye) style shall be provided (special tool required, available at additional cost).

#### Finish:

Finish shall be Beacote III polyester powdercoat electrostatically applied and thermocured. Wall brackets & Crossarms shall be subjected to iron phosphate chemical pre-treatment prior to painting by immersion process.

#### Crossarm Details

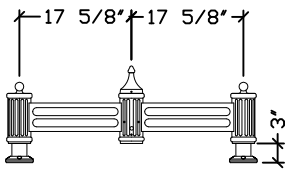

Pendant Mounting

#### Wall Bracket Details

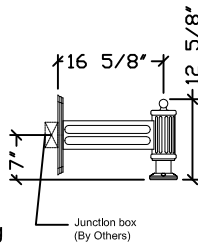

Junction box (By Others)

#### Pendant Luminaire Mounting Details

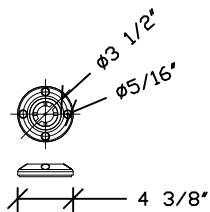

#### Optional Finials

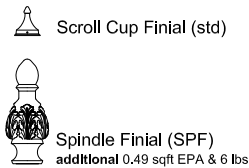

#### Wall Mounting Details

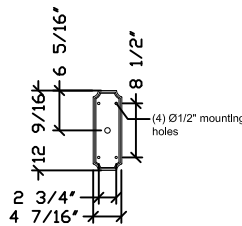

### Ordering Example:

AA-65 / B / P / BB

AA-65 / / / / /

### Arrangement | EPA index (ft<sup>2</sup>) / weight (lbs)

		A	B	C	D	E	F	G	H	I	J
Shaft Ø	Weight	16lbs	-	-	-	-	-	-	-	-	-
	EPA	-	1.48	3.18	3.18	-	-	-	-	-	-
Arm	Weight	-	16lbs	29lbs	31lbs	-	-	-	-	-	-

#### Optional Finials

- SPF spindle finial

#### Finish

- BB black
- BZ bronze
- BG green
- BW white
- BY gray
- RAL RAL-
- OTHER \_\_\_\_\_

Consult factory for premium and verde finishes. Custom colors available.

#### Luminaire Mounting

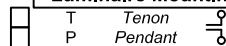

\*\* Consult factory